



FANATEC



WORLD CHALLENGE

ASIA

POWERED
BY **aws**

TEAM MANAGERS' MEETING

SUGO INTERNATIONAL CIRCUIT 2022

件名: 公式チームスタッフ写真 - 菅生大会

Official team, staff photo Friday at 14:00 (sharp).

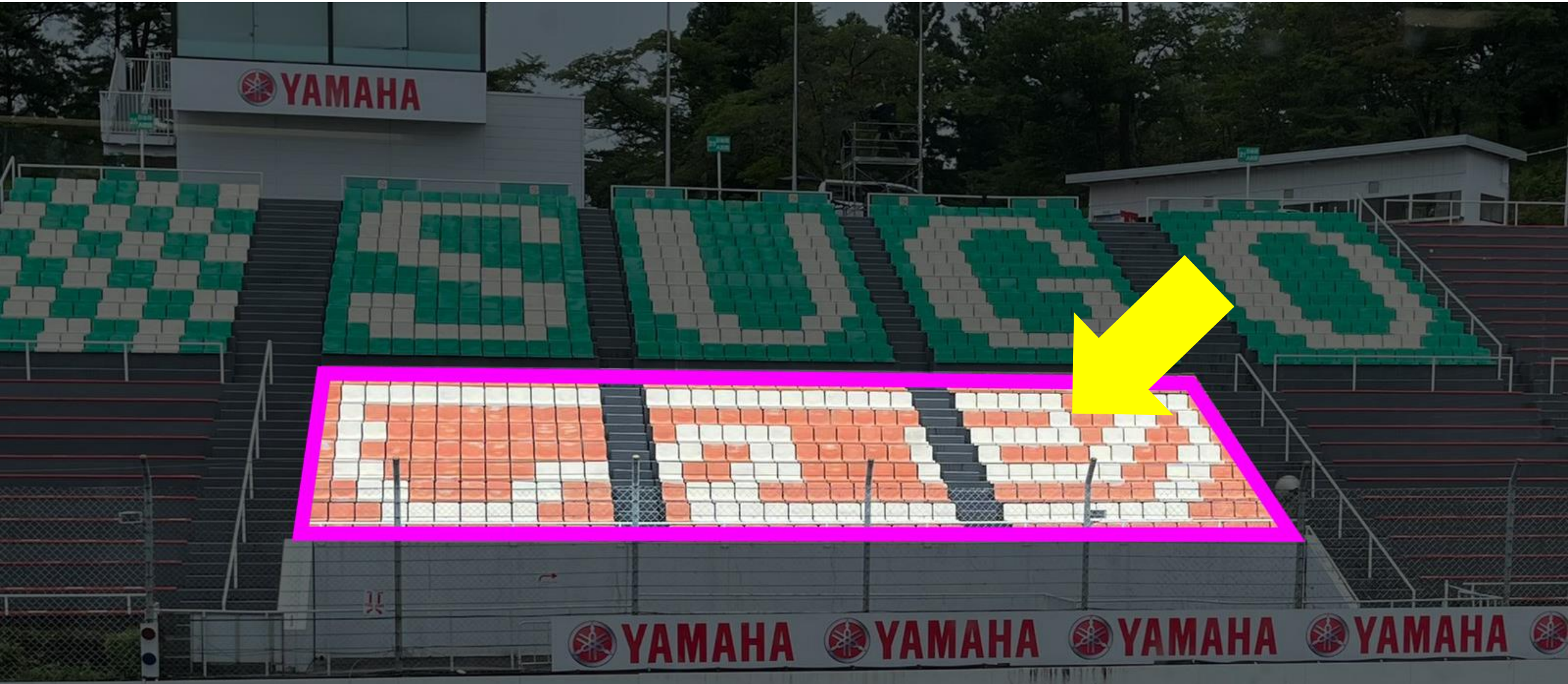

-
- Radio Check - 15 minutes before each session
 - Answer "OK" + Car # on the SRO team messaging system
 - **ONLY in the FIRST Session of the Day.**



PIT EXIT ACCESS TO TRACK



PIT EXIT DEMARCATATION LINE

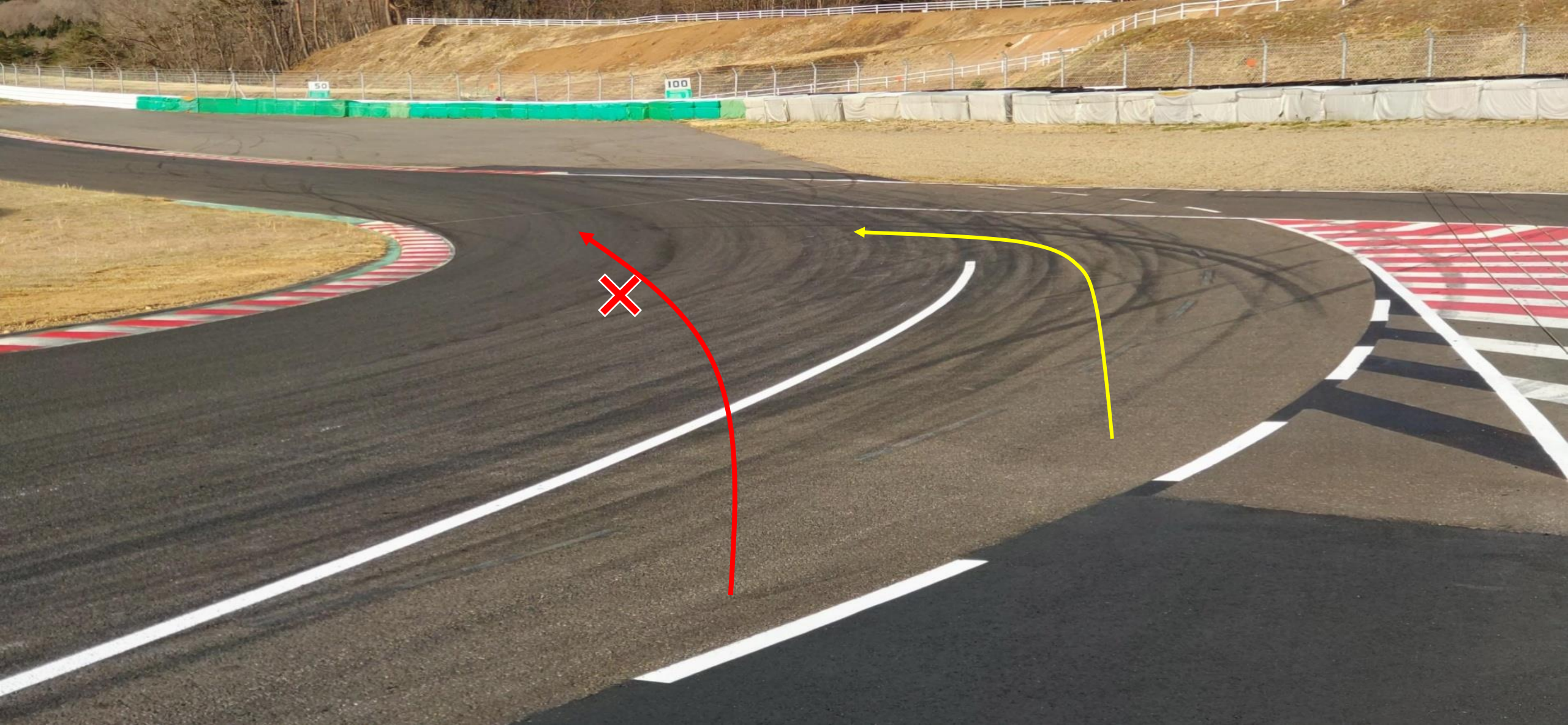

PIT EXIT DEMARCATION LINE

WHEN LEAVING PIT EXIT, NO CROSSING THIS WHITE LINE



PIT ENTRY ACCESS ROUTE

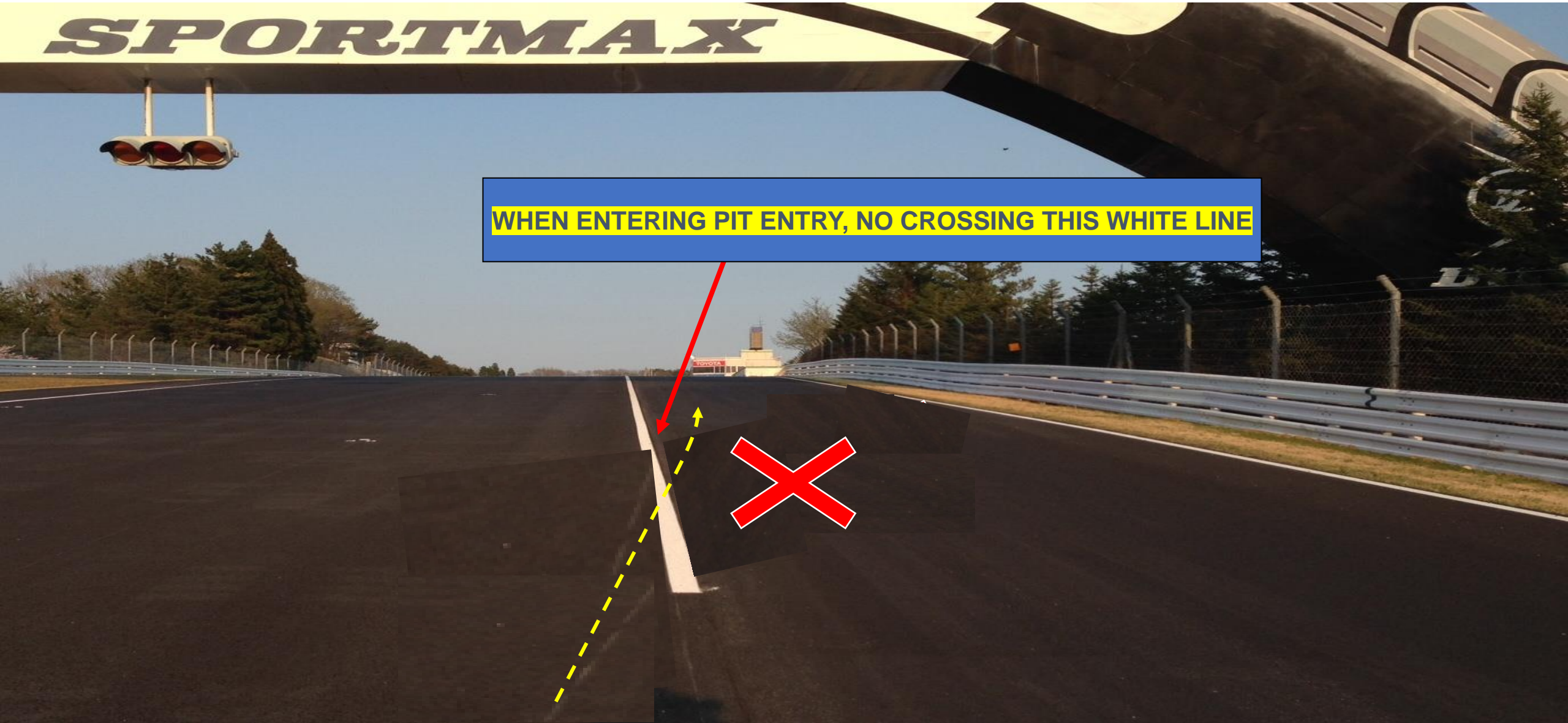

WHEN ENTERING PIT ENTRY, NO CROSSING THIS WHITE LINE



PIT ENTRY TIMING LOOP / SPEED LIMIT 50 KPH

TIMING LOOP STARTS

SPEED LIMIT LINE



PIT EXIT TIMING LOOP / SPEED LIMIT 50 KPH

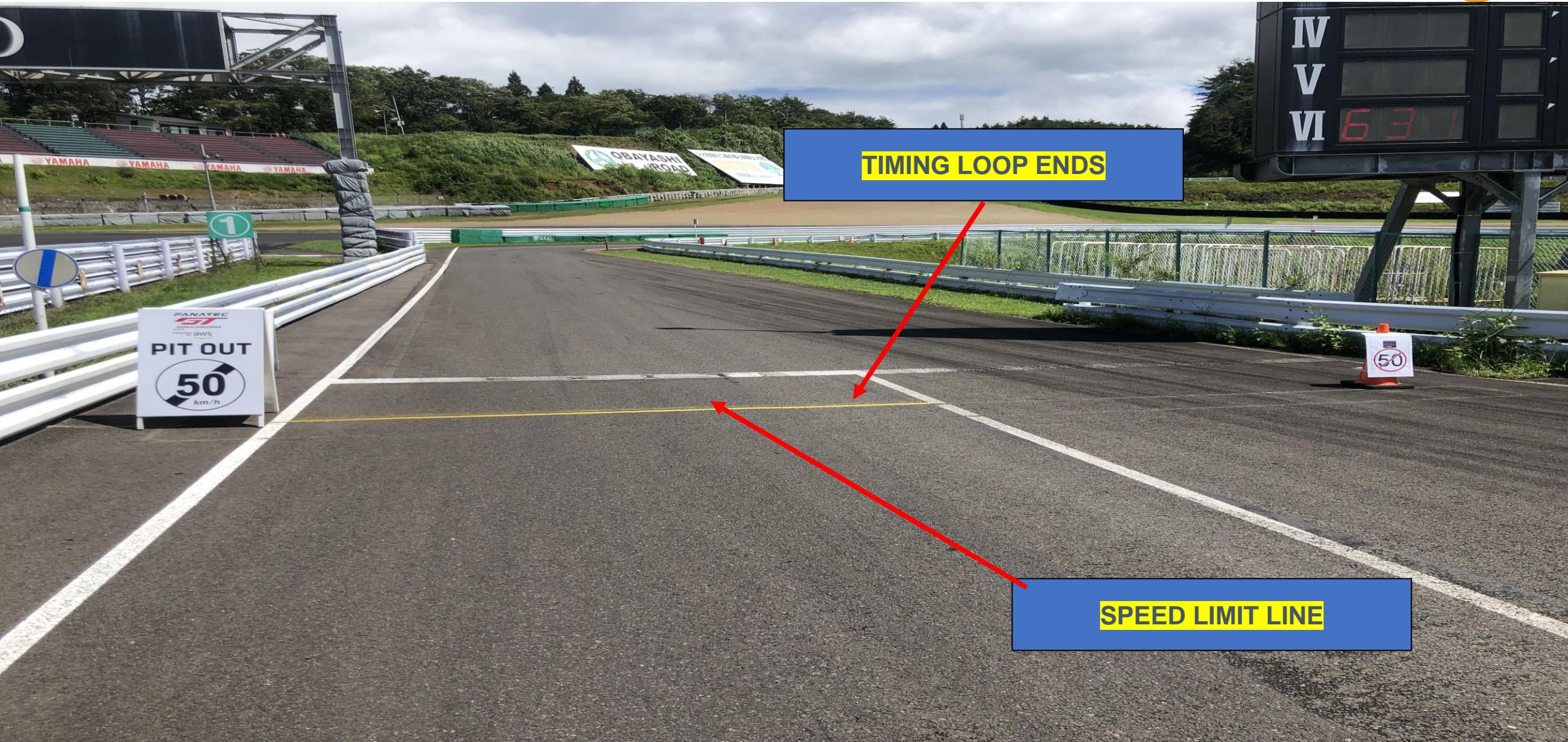

TIMING LOOP ENDS

SPEED LIMIT LINE

PIT OUT

50
km/h

50

IV
V
VI

63.1

RAISED KERBS AT TURN 5 AND TURN 6

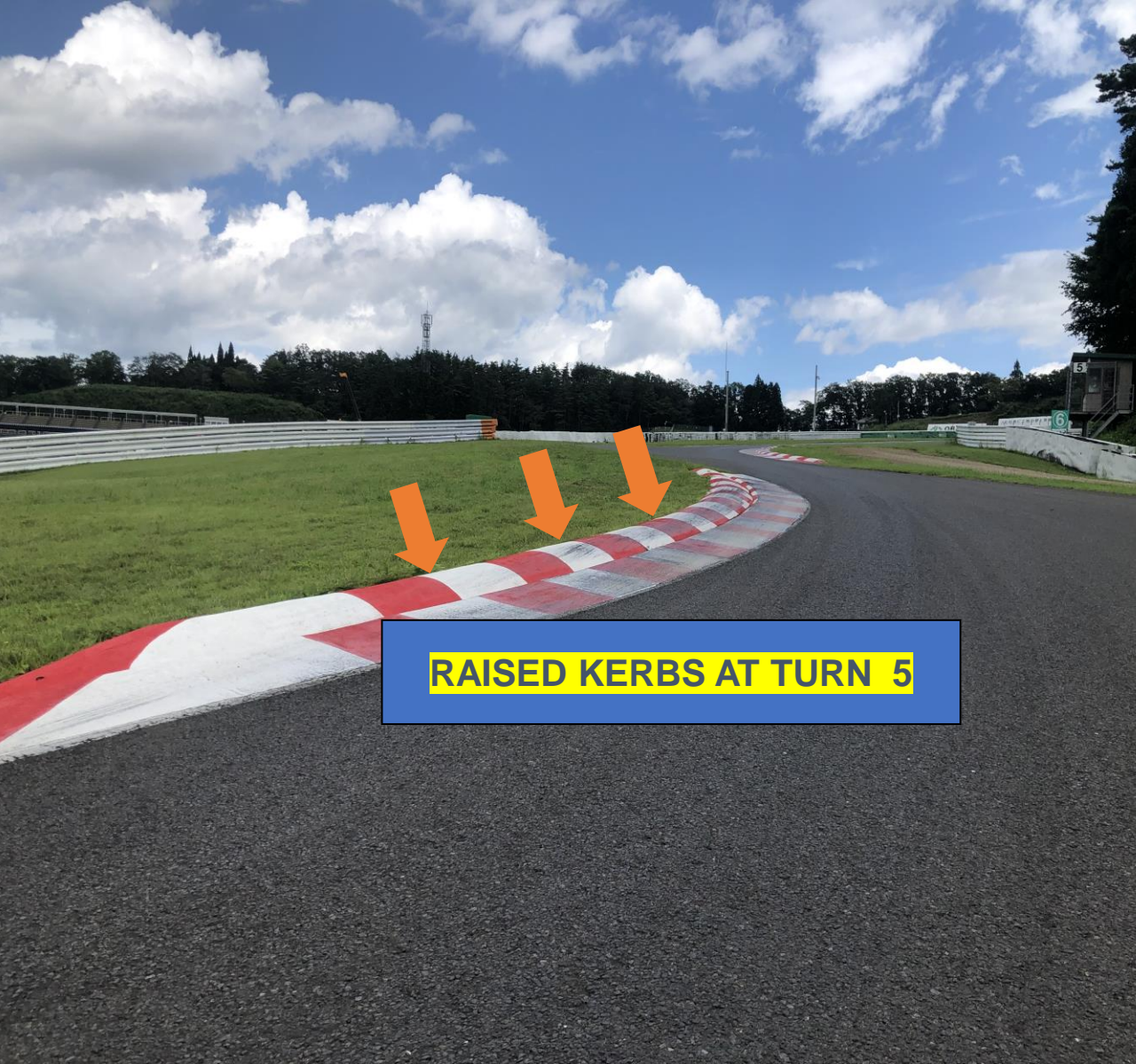

RAISED KERBS AT TURN 5



RAISED KERBS AT TURN 6

START LINE/CONTROL LINE /CHEQUERED FLAG LINE



PIT LANE WORKING AREA

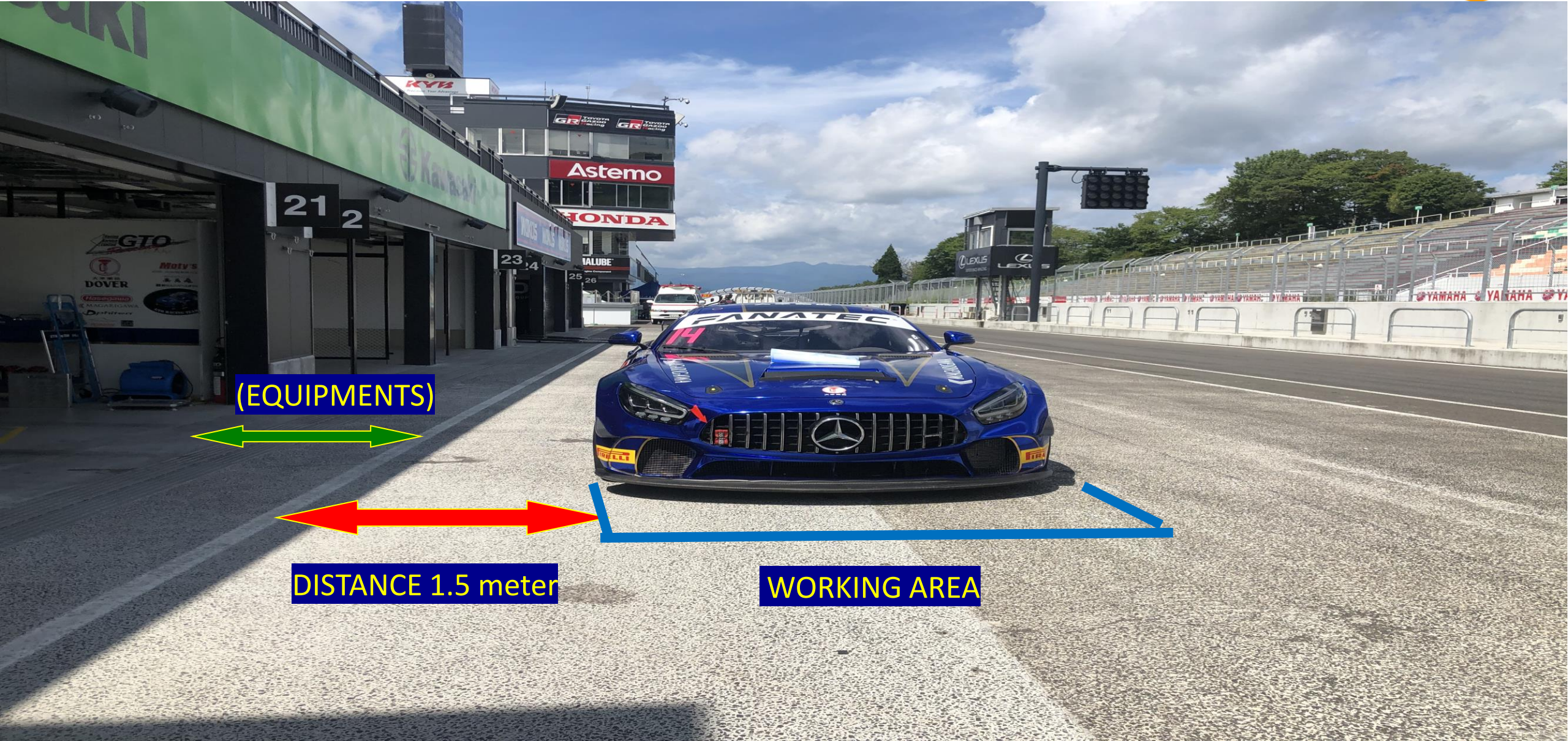

(EQUIPMENTS)

DISTANCE 1.5 meter

WORKING AREA

FAST LANE OPEN BOARD

FANATEC
GT
WORLD CHALLENGE
ASIA

POWERED BY **aws**

**FAST
LANE
OPEN**

SHOWN ONLY AT PIT EXIT LINE

DRIVE THROUGH PENALTY BOARD

FANATEC
GT
WORLD CHALLENGE
ASIA

POWERED BY **aws**

**DRIVE
THROUGH
PENALTY**

SHOWN ONLY AT FINISH LINE

STOP & GO PENALTY BOARD

FANATEC



WORLD CHALLENGE
ASIA

POWERED BY **aws**

**STOP & GO
PENALTY**

SHOWN ONLY AT FINISH LINE

PENALTY BOARD SIGNAL AREA

DRIVE
THROUGH



LEXUS
EXPERIENCE AMAZING

LEXUS

RIDING SPORT

ヤマハ・エレクトロニクス
YAMAHA MOTOR ELECTRONICS CO.,LTD.

HONDA

HONDA

TRACK LIMITS (EXIT OF TURN 2)



TRACK LIMITS (EXIT OF TURN 8)



TRACK LIMITS (EXIT OF TURN 11)



PARC FERME POSITION IN THE PITS



START GANTRY LIGHTS (ALL RED)

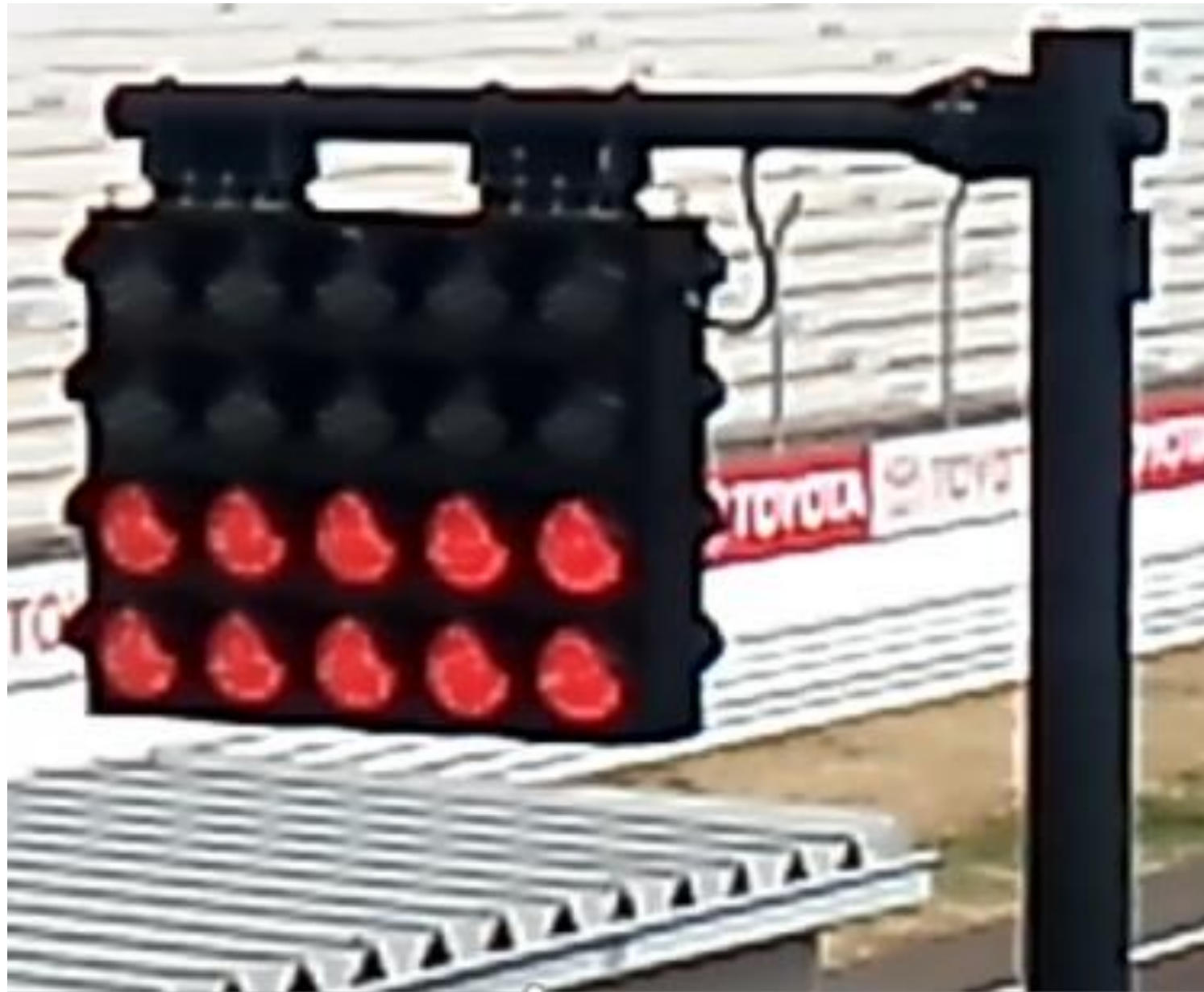

RADAR GUN TO MONITOR SPEED AT THE START

FANATEC



WORLD CHALLENGE
ASIA

POWERED BY
aws

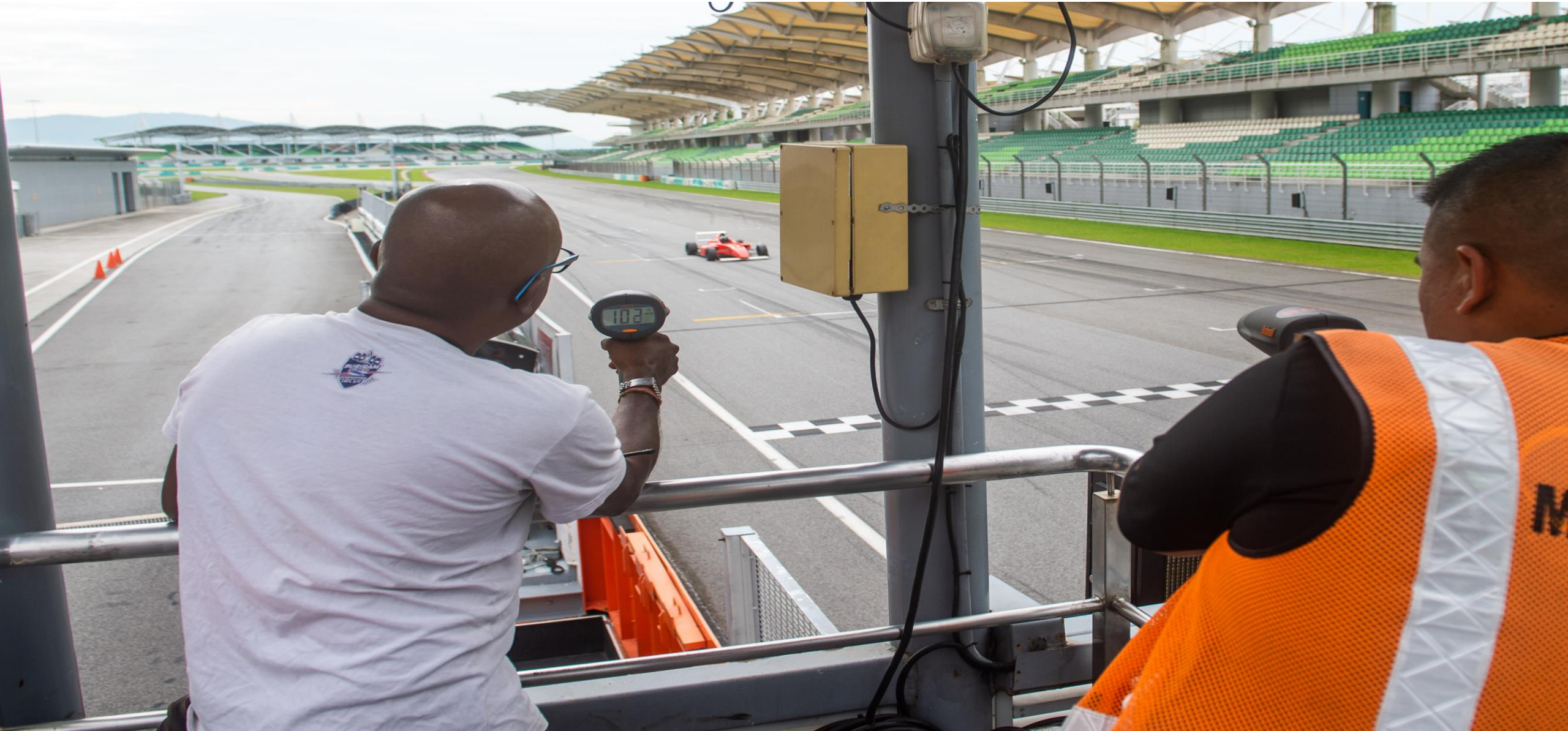

START GANTRY LIGHTS (ALL GREEN)



CHEQUERED FLAG (START LIGHTS YELLOW FLASHING)

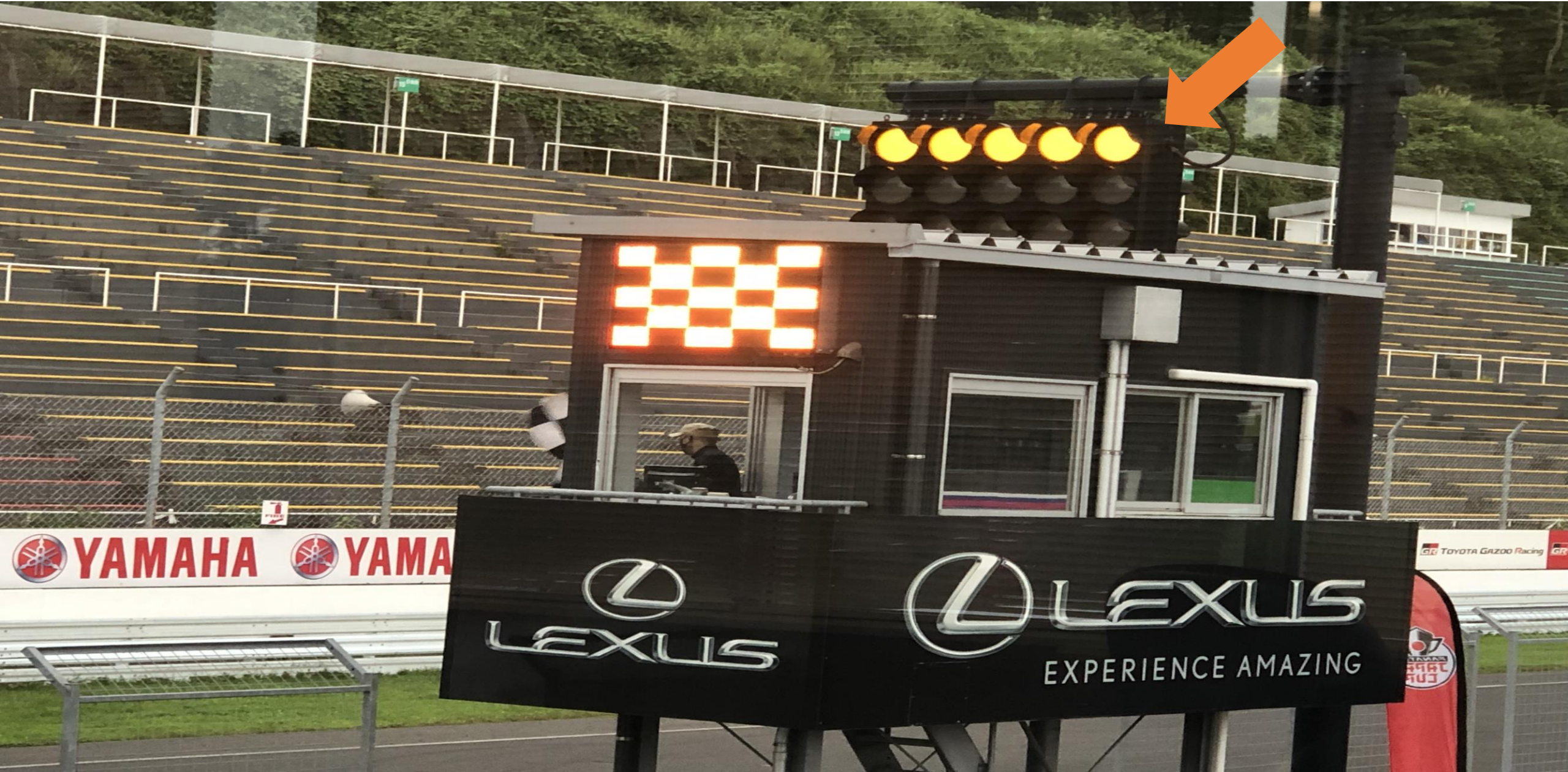

SAFETY CAR RESTART LINE

SC退去後、全ポストグリーンへ切り替え
コントロールラインを超えるまでは追越し禁止

All posts switch to green after SC leaves
No overtaking until the control line is crossed.



リスタート
Restart

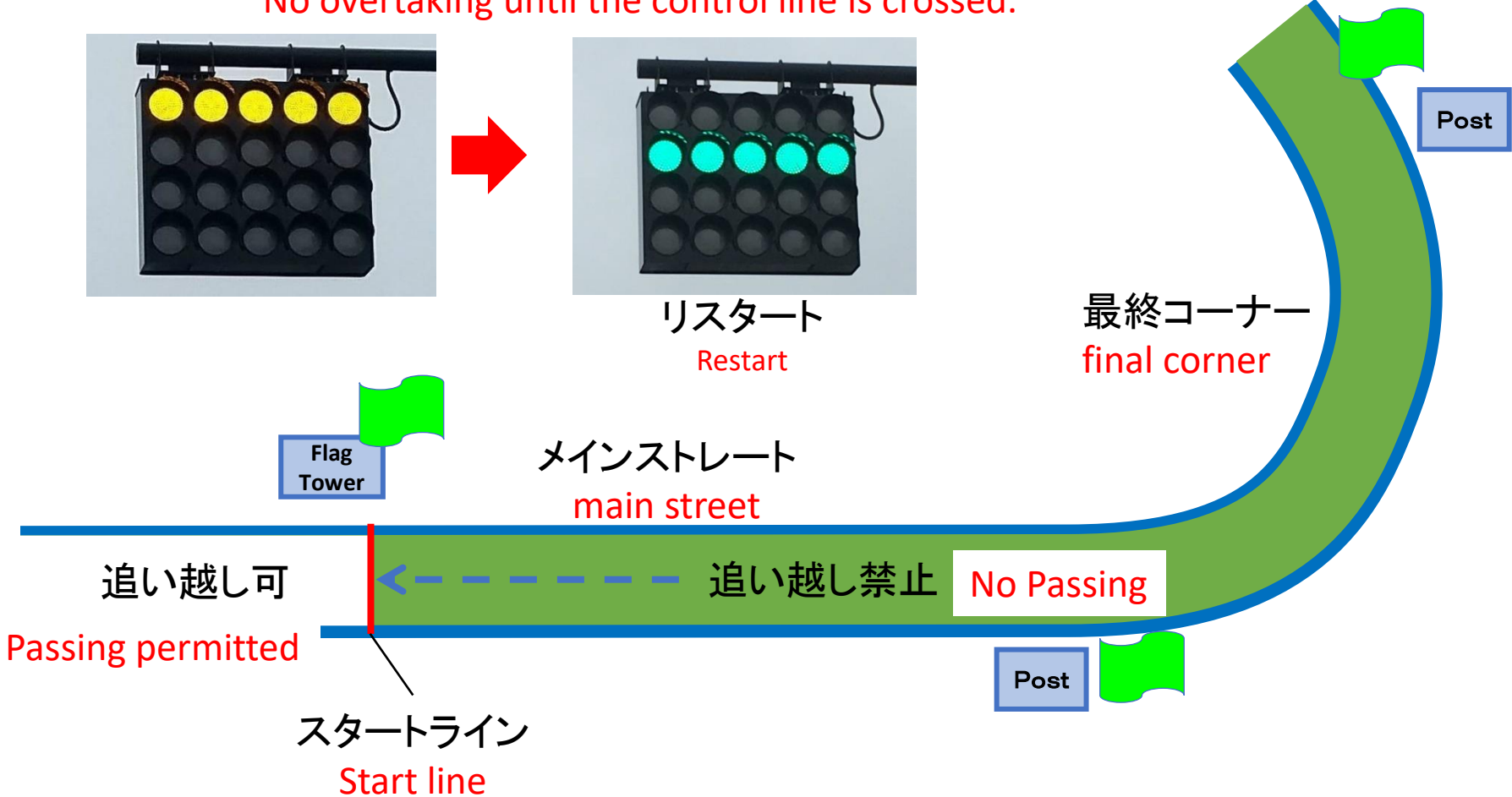

SAFETY CAR LINE 1

